

# Application for Curb Cut

Borough of Fountain Hill

941 Long Street Fountain Hill, PA 18015

*I hereby request a curb cut at the address listed below:*

ADDRESS		
Property Owner (Please Print)		Date of Application
Address		
Phone	Cell No.	Email
Property Owner Signature:		

*Sketch property below showing location of planned curb cut; of adjacent streets and/or alleys (Include measurements of planned cut)*

*You may use a separate sheet of paper if needed.*

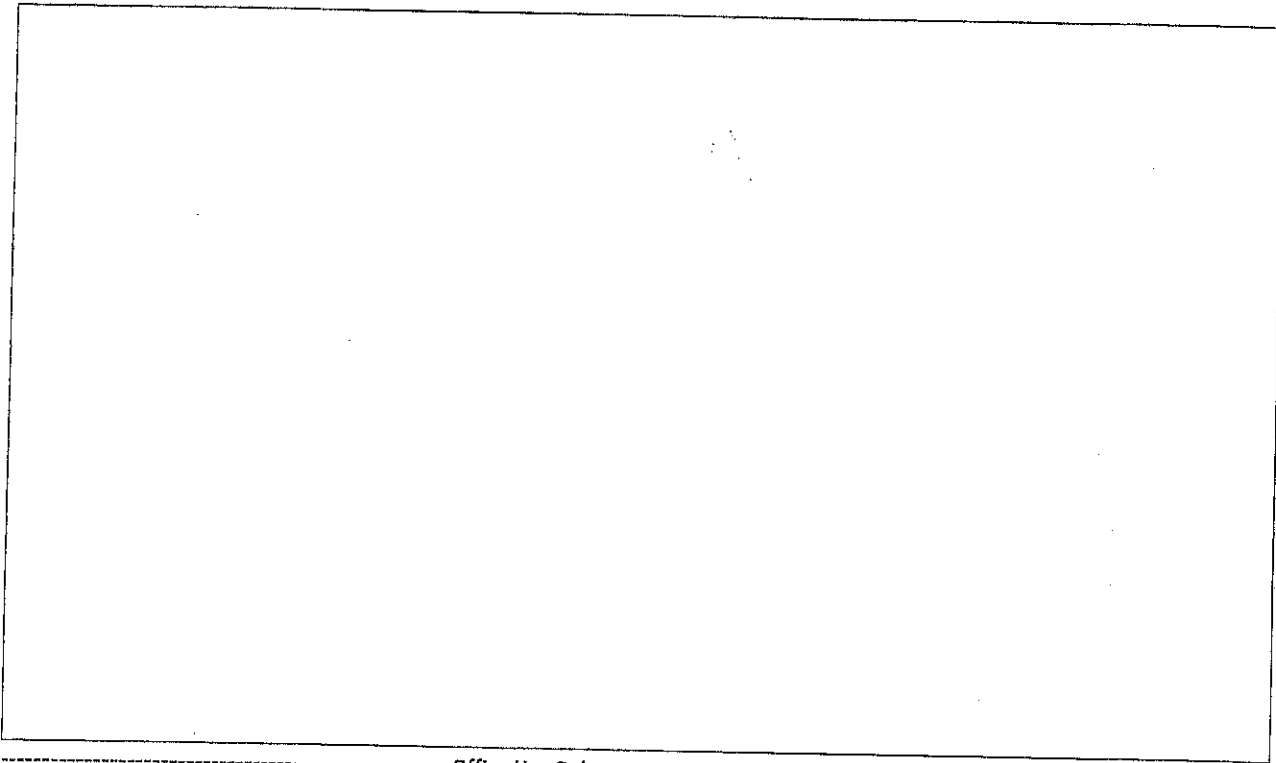

-----Office Use Only-----

Review conducted by Police Chief Date: \_\_\_\_\_

\_\_\_\_\_  
Chief of Police

Review conducted by Public Works Date: \_\_\_\_\_

\_\_\_\_\_  
Public Works Supervisor

Approved by Borough Council Date: \_\_\_\_\_

\_\_\_\_\_  
Zoning Officer

## FOUNTAIN HILL BOROUGH

### STANDARD SPECIFICATIONS FOR THE CONSTRUCTION OF CURB AND SIDEWALK

June 2009

#### I. GENERAL SPECIFICATIONS AND REQUIREMENTS

##### A. GENERAL

The following standard specifications are to be used in the construction, reconstruction or repair of curb, gutter, sidewalk and driveways abutting any public street in Fountain Hill Borough, Lehigh County, PA. Ordinance 355 - Streets and Sidewalks, Section 404 requires that such work shall be performed in strict conformity with the plans and specifications of the Borough Engineer.

##### B. PERMITS AND FEES

Any person desiring to construct curb, gutter, sidewalk or driveways abutting a public street must obtain a Warrant of Survey and Permit and pay such fees as are described by Ordinance 355 and as amended from time to time by Borough Council.

##### C. INSURANCE

The designated Contractor shall provide the Borough with a copy of their public liability insurance policy insuring the Borough as well as the individuals completing the work, against any loss or damage to persons or property resulting from the work being done in such amount as shall be deemed adequate by the Borough. In place of the Contractor providing a copy of their liability insurance, the property owner can provide evidence of his or her home owner's insurance policy for the property where work is to be completed.

##### D. SURVEY

After the Owner or designated Contractor has obtained a Warrant of Survey, the Borough Engineer will inspect the site and, if required, will survey the site. The Borough Engineer will provide to the Owner or designated Contractor the required line and grade for construction of the curb, gutter, sidewalk and driveways. The line and grade generally will consist of "stakes" and a "cut sheet". Stakes may be actual stakes driven into the ground or painted marks on paving. The cut sheet indicates the horizontal and vertical measurement from the stake to the line of the curb, gutter, sidewalk or driveway and may include sketches of the installation. At the discretion of the Borough Engineer alternative methods may be utilized to indicate the line and grade.

All construction must comply with the line and grade provided by the Borough Engineer and with the details and specifications herein or as modified by the Borough Engineer. In developed areas with existing sidewalk and curb the Engineer may modify the details and specifications to conform with existing construction.

Broadway is a State Highway. Any curb or paving work on Broadway must be first approved by PennDOT, Lehigh County Permits Department. Sidewalk on Broadway may be constructed with only a Borough permit.

##### E. UTILITY NOTIFICATION

In accordance with P.L. 852, Act No. 287 of December 10, 1974, as amended, if the Work involves any "excavation" as defined in the Act, the Owner's designated Contractor shall notify all "Users" (Utilities) that he will be making an excavation at least three (3) working days prior to the

day of beginning such work so that each "User" can mark or locate their lines for the Contractor in the area of excavation.

The Contractor shall indicate that he has notified all "Users" by supplying to the Borough Engineer a list of the date(s) of utility location inquiry and all Serial or Code Numbers received from the appropriate "Users" (Utility Companies) or the PA One Call System.

The Contractor shall be responsible for notifying the appropriate utility company if any valve or curb box replacements or adjustments are needed as a result of the work being completed.

F. INSPECTIONS

The Owner or designated Contractor shall notify the Borough Engineer at the start of work and a minimum of 48 hours prior to beginning any work which requires an inspection. See Section III and IV for specific information regarding required inspections for curb and sidewalk, respectively.

G. PROTECTION OF WORK

The Owner's designated Contractor shall have full responsibility for the labor, equipment, and material for the work being completed and shall be fully responsible for all employee and public safety during any portion of the work.

The Contractor shall place barricades, lights, signs, and other protective devices along and across open trenches and shall set up and maintain any advance warning signs and temporary traffic control required, as a result of his work.

H. PROTECTION OF PUBLIC AND PRIVATE PROPERTY

The Owner's designated Contractor shall take great care to protect all public and private property. If the construction work undertaken by the Contractor, his equipment, his agents, or subcontractors causes damage to public or private property, the Contractor will be responsible for the satisfactory repair or replacement of the damaged property and/or the costs of any legitimate monetary damages due as a result of such damage.

I. TRAFFIC CONTROL AND PROTECTION

The Contractor shall provide, place, and maintain all job warning and traffic control signs and devices required to protect the traveling public. All signing, barricading, and flagging operations shall be provided in accordance with the current MUTCD and the current PennDOT Chapter 212 "Work Zone Traffic Control Guidelines" regulations as found in Part 1 of Title 67 Pennsylvania Code, commonly known as Publication 21. The Contractor and all personnel implementing traffic control measures shall be responsible for being familiar with the requirements of Publication 213.

At no time shall the work or the actions of the Contractor or his personnel prevent or deny access to public or private properties by law enforcement or emergency vehicles or personnel. Implement traffic control in accordance with applicable figures of PennDOT Publication 213.

J. CLEANING THE SITE AND GRASS RESTORATION

Upon completion of the work, the Owner's designated Contractor shall clean the site and remove from it and from adjoining and adjacent property all equipment, surplus and discarded materials remaining from his operations. He shall leave the area of work and surrounding surfaces in a thoroughly satisfactory, presentable condition.

All disturbed grass areas shall be restored with six inches (6") of clean topsoil, raked, fertilized, seeded, and mulched as required

## K. MAINTENANCE

Borough Ordinances specify that the maintenance of curb, sidewalk and planting strip is the responsibility of the owner of the property abutting any ordained or dedicated street in the Borough.

## L. CONSTRUCTION SEASON

1. General Improvements: The installation of improvements shall be completed between March 15th and December 31st, of any year. No improvements shall be completed after December 31st or before March 15th, unless written permission is granted from the Public Works Supervisor or Borough Engineer.
2. Placement of Paving Mixtures: The installation of bituminous paving mixtures generally shall be completed between April 1st and October 15th of any year. Bituminous paving mixtures placed after October 15th or before April 1st shall require written approval by the Public Works Supervisor or Borough Engineer. In addition, bituminous paving mixtures shall not be placed when prohibited by weather as specified in Section 401.3 of PennDOT Publication 408 and Section 3.A.10 of this Ordinance.
3. If bituminous paving mixtures need to be placed after December 15th or resumed prior to April 1st, the Borough will require the Owner to install temporary paving in the street. In addition the Owner will be required to sign a Street Restoration Agreement with the Borough and deposit with the Borough financial security in such amount as determined by the Public Works Supervisor or Borough Engineer to ensure completion of permanent street restoration during the approved paving season.

Trenches for temporary paving shall be backfilled with 2A crushed aggregate within 2" of the finished street surface. Temporary paving shall consist of 2" Type P-B Bituminous Stockpile Patch Material (cold patch). Temporary paving shall remain in place and be maintained by the Owner until permanent paving is completed by the Owner in accordance with the specifications contained here within. Upon the Public Works Supervisor's inspection and approval of the permanent street restoration, the Owner shall submit a request to the Borough for termination of the Street Restoration Agreement and reimbursement of the financial security.

## II. TECHNICAL SPECIFICATIONS

### A. GENERAL

Materials and installation shall comply with the latest edition of the following specifications. ACI - American Concrete Institute, ASTM - American Society for Testing Material, PennDOT Specification 408.

### B. MATERIALS

#### 1. CONCRETE

- Minimum compressive strength 3,300 psi at 28 days.
- Minimum cement content - 564 lbs. per cubic yard of concrete (PennDOT Class A Concrete).
- Cement - ASTM C150.
- Aggregates - ASTM C33-07 - Maximum size 1 1/4 inches.
- Water - Clean, potable.
- Air entrainment - ASTM C260 (6% ± 1%).
- Additives - ASTM C494, ACI C618, and ACI C1017 - Accelerants, decelerants and plasticizers are permitted per ACI. Sodium chloride not permitted.

All material slips shall be submitted to the Public Works Supervisor or Borough Engineer.

**2. REINFORCING**

ASTM A185 OR A497 welded wire fabric.  
ASTM A615 reinforcing bars.

**3. EXPANSION MATERIAL**

1/2-inch thick bituminous expansion joint filler - ASTM D994 or D1751. Wood is not acceptable.

**4. STONE**

PennDOT Type 2A crushed limestone required, unless an alternate aggregate deemed appropriate by PennDOT Specification 408, is approved for use by the Public Works Supervisor and/or Borough Engineer. Cinders, soil, rubble, frozen material, excessively wet material are not acceptable.

**5. STREET PAVING**

The design mix for the Hot Mix Asphalt Base Course and Wearing Course shall be determined by the Borough Engineer based upon traffic characteristics of the roadway. Generally the following material shall be used:

- a. Superpave Base Course - 25.0 mm, PG 64-22, 0-0.3 million ESAL's, average design thickness 4".
- b. Superpave Wearing Course - 9.5 mm, PG 64-22, 0-0.3 ESAL's, SRL "M", average design thickness 1 1/2".

All material slips shall be submitted to the Public Works Supervisor or Borough Engineer.

**6. SEALING MATERIAL**

Any sealant material approved by PennDOT for this type of use. Apply in accordance with PennDOT Specifications 408.

**C. INSTALLATION**

**1. CONCRETE**

Mixing, forming, placing, finishing and curing in accordance with ACI 318.  
Cold Weather - ACI Committee 306 Recommendations  
Hot Weather - ACI Committee 305 Recommendations

**2. BACKFILL**

Backfill shall not be placed on frozen soil, ice, mud or free standing water. Backfill shall be properly compacted.

**3. PAVING**

Place, roll, compact, and seal in accordance with PennDOT 408.

**D. DESIGN**

**1. CURB (ADA) RAMPS**

Curb ramps shall comply with the Universal Accessibility Standard required by The Americans with Disabilities Act (ADA) for curb ramps at sidewalks.

### III. CURB CONSTRUCTION

#### A. LOCATION

The location of curbs shall be at the discretion of the Borough Engineer. The location shall be based on required street widths or in accordance with the approved plan for a subdivision or site development. Location may also be based upon conformity with the existing curb on adjacent properties and along the street in the general area, and also upon any other features such as trees or steep slopes which may effect construction, safety and use.

The top of the curb shall be located at a height as specified by the Borough Engineer's design grades. Generally the curb should be six (6) to seven (7) inches above the top of the finished paving of the street.

#### B. CURB CUT SHEETS

Curb cut sheets for individual properties generally will be prepared and provided by the Borough Engineer in accordance with Section I.D. of these specifications.

For land development projects or subdivisions, the Borough Engineer may require the property owner or Contractor to prepare the curb cut sheets. Cut sheets shall then be submitted to the Borough Engineer for review a minimum of three (3) working days prior to pouring of the curb. The stake out for the curb shall have stakes at a maximum spacing of 10 feet on all curves and 20 feet on all straight or tangent sections. The stakes shall be set at all points on curve and points on tangent of all curves and identification numbers shall be indicated on the stakes and cut sheets.

#### C. INSPECTION

The Borough Engineer shall be notified a minimum of 48 hours prior to the need for an inspection. Inspection of the curb is required at the following stages of construction:

1. After the soil subgrade has been prepared for placement of the crushed aggregate subbase to ensure proper grading and compaction.
2. After placement of the forms and crushed aggregate subbase to ensure proper curb depth, horizontal and vertical alignment, and materials prior to pouring concrete.

#### D. UTILITY NOTIFICATION

Before excavating for curbs the Owner or designated Contractor must by law notify all companies who may have utilities buried in the area. A call to PA One Call 1-800-242-1776 at least three working days before digging will automatically notify all utilities.

#### E. SIZE AND CROSS SECTION

The curb shall be a minimum of 22 inches deep with a top width of six (6) inches and a bottom width of eight (8) inches. The back of the curb shall be vertical and the front face of the curb shall be inclined as shown in Detail A. The top edges of the curb shall be rounded to a 1/2-inch radius.

NOTE: See Details A and B for typical details of curb construction.

#### F. CORNERS AND DRIVEWAYS

The radius at street corners, alleys, and driveways shall be as determined by the Public Works Supervisor or Borough Engineer and/or approved subdivision or site development plan.

#### G. FORMS

The curb forms shall be made of appropriate materials, preferably steel forms. The curb forms must be inspected by the Borough Engineer for proper curb depth, horizontal and vertical alignment, and materials before the concrete is poured. Flexible curb forms shall be used at all curved curbs with a centerline radius of less than 500 feet. Forms may be omitted below the street level only if approved by the Public Works Supervisor or Borough Engineer. If approved, the excavation sides must be clean and straight. If forms are omitted, one (1) inch shall be added to the required thickness of the curb below grade.

#### H. BASE

The curb excavation must be clean and free of refuse, water, mud or frozen material. The base must be firm and covered with a two (2) inch thick layer of compacted crushed stone.

#### I. EXPANSION JOINTS

Expansion joints shall be 1/2-inch thick premolded bituminous expansion material. Expansion joints shall be placed at a spacing between joints of a maximum of 30 feet along the curb and shall be placed next to buildings, poles, structures, sidewalks and driveways and at the tangent points of curves.

#### J. CONTRACTION JOINTS

Contraction joints shall be spaced at approximately equal intervals between expansion joints. Maximum spacing of contraction joints shall be 10 feet. Contraction joints shall be formed by division plates.

#### K. REINFORCING

Steel reinforcing is not required in curbs.

#### L. MATERIAL

All curbs shall be constructed of concrete with a minimum compressive strength of 3,300 psi at 28 days. Concrete shall be PennDOT Type A Concrete or better. Concrete must be air entrained to enhance its resistance to freezing.

#### M. FINISH

After concrete is placed into the forms, it shall be worked thoroughly to ensure proper mixture and to eliminate any air pockets in order to provide a uniform and smooth side. Forms shall be removed and checked for honeycomb or large air holes before the concrete has completely set and while the concrete is still green. Any defects shall be properly corrected.

#### N. CURING

In order to allow the concrete to properly cure and achieve a hard, freeze and salt resistant surface it must be kept wet for a minimum of three (3) days after it is finished. A curing agent, plastic or burlap cover, occasional spraying, or any other acceptable method may be used.

#### O. COOL AND COLD WEATHER CURING

For all concrete placed at temperatures below 50°, follow the requirements of PennDOT Publication 408, Section 1001.3(P)(4) and (5) for protection of concrete. All placement of concrete below 40° must have prior approval of the Borough Engineer.

P. BACKFILL

On the street side of the curb, backfill shall be 2A crushed limestone. On the sidewalk side, backfill may be crushed stone or clean dirt or topsoil. All backfill must be well tamped.

Q. STREET REPAIR

When a curb is constructed in an existing street, the street paving shall be repaired in accordance with the direction of the Public Works Supervisor or Borough Engineer. Minimum street repair shall be:

1. Cut the existing paving with a straight vertical cut removing any paving damaged by the excavating.
2. Backfill with tamped stone to within five and one-half (5 1/2) inches of the final paving grade.
3. Pave with four (4) inches of properly compacted Hot Mix Asphalt Base Course. See Section II.B.5.a. for paving specifications.
4. Finish paving with one and one-half (1 1/2) inches of Hot Mix Asphalt Wearing Course. See Section II.B.5.b. for paving specifications.
5. The final grade of the paving must be sloped toward the curb to form the gutter in accordance with the line and grades established by the Borough Engineer. Minimum slope shall be 1/4 inch per foot of paving measured perpendicular to the curb. At intersections, catch basins, etc. particular care must be taken to construct the proper grade for positive drainage.
6. Seal the joints between the paving and the curb and between the new paving and the existing paving with hot bituminous material or emulsified asphalt of a type approved by PennDOT.

R. DRIVEWAYS

Except for the replacement of an existing depressed curb, installation of a depressed curb for a driveway must be approved by Borough Council before it is installed. The top of curb at a driveway should typically be one (1) inch above the finished street surface, unless otherwise directed by the Public Works Supervisor or Borough Engineer. Transition from full depth curb to depressed curb shall be provided in accordance with ADA and PennDOT Publication 72M (RC-67M) for driveway aprons.

S. CURB (ADA) RAMPS

Curb ramps shall be constructed at intersections in accordance with current Americans with Disabilities Act (ADA) regulations and PennDOT Roadway Construction Standards (Publication 72M). See Section IV and Details A and B for general design and construction standards.

T. TREE PLATES

Where there are existing trees close to the curb whose roots may be damaged by the excavation and/or construction of curb, tree plates may be installed in place of concrete curb with permission of the Public Works Director or Borough Engineer. Tree plates shall be a steel plate at least twelve (12) inches wide and three-eighths (3/8) inch thick. Each end of the plate shall extend between four (4) to six (6) inches past the end of the adjacent concrete curb. See Detail C.

U. DRAIN PIPES

Roof drains conducted to the street gutter shall consist of a pipe placed under the sidewalk and through the curb, unless otherwise approved by the Public Works Supervisor or Borough

Engineer. Roof drains shall be formed of three (3) inch diameter plastic pipe embedded in the concrete. The pipe must slope downward toward the street with a minimum slope of one-quarter (1/4) inch per foot of pipe. The inside bottom (invert of the pipe) must be at or above the elevation of the street paving and the top of the pipe must be at least two (2) inches below the top of curb. A tooled joint shall be provided in the concrete above the centerline of the pipe, from the face of curb to the back of the sidewalk, to prevent cracking in the sidewalk.

#### IV. SIDEWALK CONSTRUCTION

##### A. LOCATION

The location of sidewalk shall be at the discretion of the Borough Engineer. The standard location shall be twenty-four (24) inches from the street face of the adjacent curb and no closer than one (1) foot from the property line. The location may also be based upon conformity with the existing sidewalk on adjacent properties and along the street in the general area, and also upon any other features such as trees or steep slopes which may affect construction, safety and use of the sidewalk. In any case, the sidewalk shall always be located within the public right-of-way between the edge of the street and the property line.

##### B. ELEVATION/GRADE

Sidewalks typically shall be constructed to the required slope based on the adjacent top of curb elevation. If only sidewalk work is being completed and the adjacent existing curb is in poor condition or not at the proper grade as determined by the Public Works Supervisor or Borough Engineer, the Borough Engineer will survey the site and provide to the Owner or designated Contractor the required line and grade for construction of the sidewalk. The line and grade generally will consist of "stakes" and a "cut sheet". No sidewalk work in the public right-of-way shall commence until the Public Works Supervisor or Borough Engineer has conducted a site visit to determine if survey work and cut sheets will be required for construction of the sidewalk.

##### C. INSPECTION

The Borough Engineer shall be notified for inspection of the sidewalk at the following stages of construction:

1. After the soil subgrade has been prepared for placement of the crushed aggregate subbase to ensure proper grading and compaction.
2. After placement of the forms and crushed aggregate subbase to ensure proper depth, grading, and compaction.

##### D. WIDTH

The width of the sidewalk shall be based upon conformity with the existing sidewalk on adjacent properties and along the street in general area, or at the discretion of the Public Works Supervisor or Borough Engineer. Typically the standard width of sidewalks shall be four (4) feet, except along major streets (Broadway and Delaware) and adjacent to shopping centers, schools, recreation areas and other community facilities where the standard width shall be five (5) feet.

NOTE: See Details A and B for typical details of sidewalk construction.

##### E. THICKNESS

All sidewalks shall be a minimum of four (4) inches thick underlain by three (3) inches of compacted crushed stone, except where the sidewalk is part of a driveway. Driveway aprons

shall be a minimum of six (6) inches thick underlain by six (6) inches of compacted crushed stone and be uniformly sloped from the back of the sidewalk to the curb.

F. SLOPE

The sidewalk must be uniformly sloped from the back of the sidewalk to the curb such that the sidewalk drains toward the curb. The slope shall be a minimum of 1/4-inch per foot to a maximum of 3/8-inch per foot.

G. EXPANSION JOINTS

Expansion joints shall be 1/2-inch thick premolded bituminous expansion material. Expansion joints shall be placed at a spacing between joints of a maximum of 30 feet along the sidewalk and next to buildings, poles, structures and curbs; around intersections of two sidewalks and at intersections with driveways. All joint material shall be trimmed to conform to finish grade.

H. CONTRACTION JOINTS

Contraction joints shall be spaced at equal intervals between expansion joints. Maximum spacing of contraction joints shall be five (5) feet. Contraction joints shall be formed by division plates or by cutting or tooling a groove into the concrete surface not less than 1/3 the depth of the concrete slab.

I. REINFORCING

Steel reinforcing is not required in sidewalks that are not part of a driveway, but may be used at the discretion of the Owner. Where the sidewalk is part of a driveway it shall be reinforced with wire fabric a minimum of 6" x 6" x 10 gauge size.

J. CROSS SECTION

Detail A shows the typical construction details for sidewalks.

K. MATERIAL

All sidewalks shall be constructed of concrete with a minimum compressive strength of 3,300 psi. PennDOT Type A concrete is acceptable. Concrete must be air entrained to enhance its resistance to freezing.

L. COOL AND COLD WEATHER

Concrete should not be poured when the temperature is below 50 degrees or if freezing temperatures are anticipated unless proper care is taken to keep the concrete from freezing. Cool and cold weather concrete placement shall follow the requirements of PennDOT Publication 408, Section 1001.3(P)(4) and (5) for cool and cold weather protection of the concrete. All placement of concrete below 40° must have prior approval of the Borough Engineer.

M. FINISH

The surface of the sidewalk should be finished with a wood float or slightly roughened fine broom finish. Excessively smooth finishes, which will create a slipping hazard when wet, will not be acceptable. Where the sidewalk slope exceeds four percent (4%) a rougher finish should be used.

**N. CURING**

In order to allow the concrete to properly cure and achieve a hard, freeze and salt resistant surface, the surface must be kept damp for a minimum of three (3) days. Curing is particularly important in very hot, dry weather. A spray-on or roll-on curing agent, plastic or burlap cover, occasional spraying, pooling of water or any other acceptable method may be used.

**O. CURB (ADA) RAMPS**

Curb ramps shall be constructed at intersections in accordance with current Americans with Disabilities (ADA) regulations and PennDOT Roadway Construction Standards (Publication 72M). See Details A and B for general design and construction standards.

**P. PLANTING STRIP**

The planting strip area between the curb and sidewalk is generally reserved for the planting of street trees and grass. The planting strip may be filled with concrete, brick, or other material if approved by the Public Works Supervisor or Borough Engineer. If concrete is used, the concrete shall conform with the specifications for sidewalk construction.

All plantings within the planting strip shall be approved by the Public Works Department or Borough Shade Tree Commission for species and location. No plantings will be allowed in the planting strip area which interfere or prohibit free passage along the sidewalk or street, or which create a hazardous condition for pedestrians or motorists. Street trees shall be located such that they are outside the required clear sight triangle at intersections.

**Q. STREET SIGNS AND UTILITY POLES**

If a street sign is located in a sidewalk area or a planting strip area to be filled with concrete or similar hard surface, a four-inch (4") diameter by eight-inch (8") long plastic pipe must be embedded in the concrete for installing the sign post. The top of pipe shall be flush with the top of concrete and the pipe filled with stone or dirt.

If a utility pole is located in a sidewalk area or a planting strip area to be filled with concrete or similar hard surface, the concrete immediately around the utility pole shall be "boxed out" using 1/2-inch thick premolded bituminous expansion material.



**NOTES:**

1. CURB AND SIDEWALK MUST BE POURED SEPARATELY (NOT MONOLITHICALLY).
2. CURB RAMPS MUST BE PROVIDED AS REQUIRED BY ADA REGULATIONS, PENNDOT PUB #72M, AND AS APPROVED BY THE BOROUGH ENGINEER.
3. DETECTABLE WARNING TRUNCATED DOMES ARE REQUIRED TO BE INSTALLED IN ACCORDANCE WITH PENNDOT PUB #72M, RC-67M.
4. LANDING DIMENSION "X" SHALL BE 4' MINIMUM WITH A MAXIMUM SLOPE OF 2%. IF X IS GREATER THAN OR EQUAL TO 4' THAN SIDE FLARES CAN BE 10:1 (10%) MAXIMUM SLOPE.
5. DETECTABLE WARNING SURFACE SHALL TYPICALLY BE 4' X 4' CAST-IN-PLACE COMPOSITE PAVER TILE UNIT, UNLESS OTHERWISE REQUIRED BY ADA OR PENNDOT PUB #72M. COLOR SHALL BE BRICK RED OR CLAY RED, UNLESS OTHERWISE APPROVED BY THE BOROUGH ENGINEER.
6. DIMENSIONS AND DETAILS MAY BE MODIFIED WITH APPROVAL FROM THE BOROUGH ENGINEER.

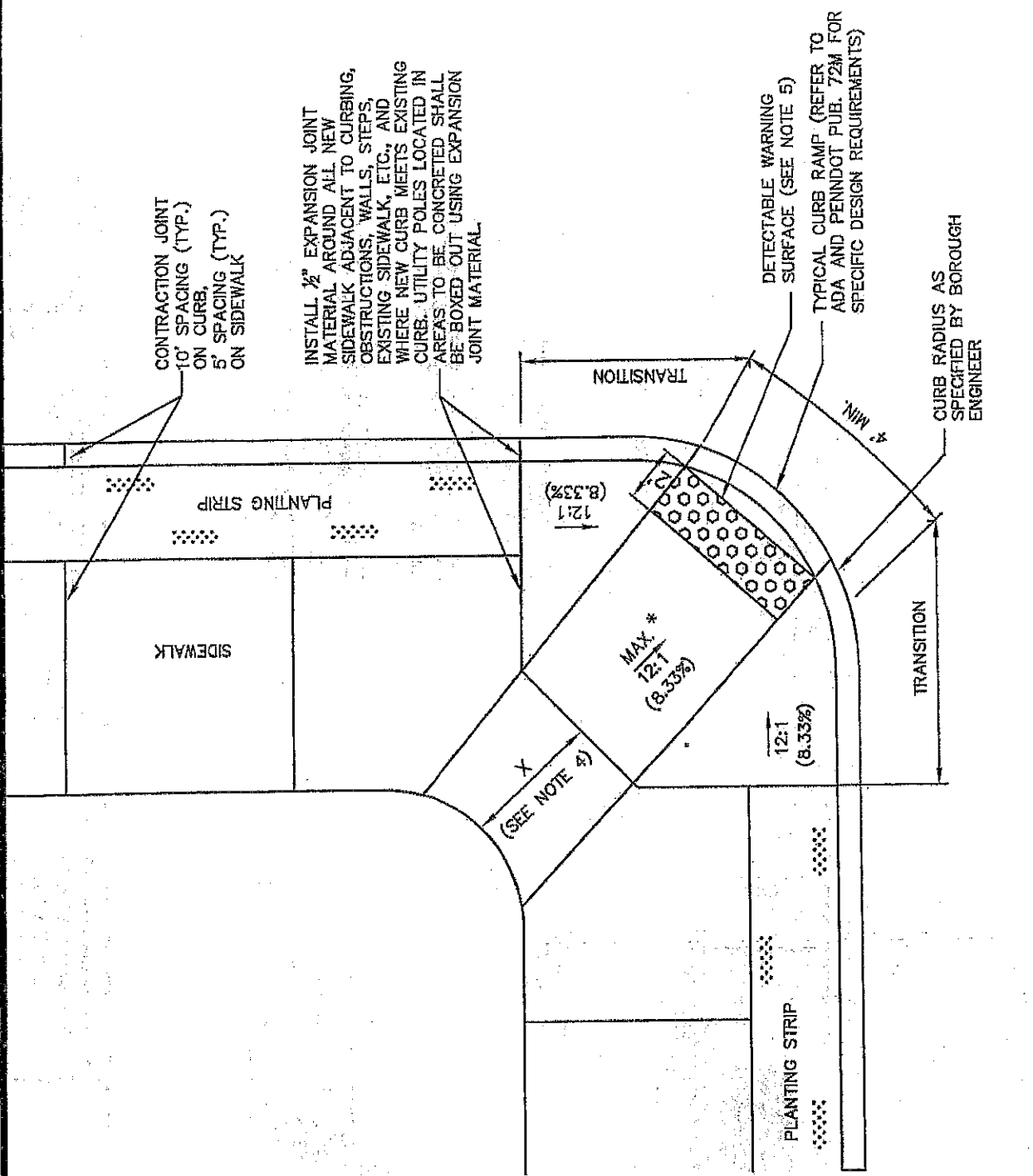

**DETAIL B - CURB/SIDEWALK PLAN**  
**FOUNTAIN HILL BOROUGH**  
**LEHIGH COUNTY**  
**PENNSYLVANIA**

CHECKED BY	JLS
DRAWN BY	ELH
DATE	JUNE 2009
SCALE	N. T. S.
SHEET NO.	1 OF 1

5920 Hamilton Blvd., Suite 108  
 Allentown, PA 18106-8942  
 610.395.9222  
 Fax 610.395.9262

**Hanover**  
 Engineering Associates Inc

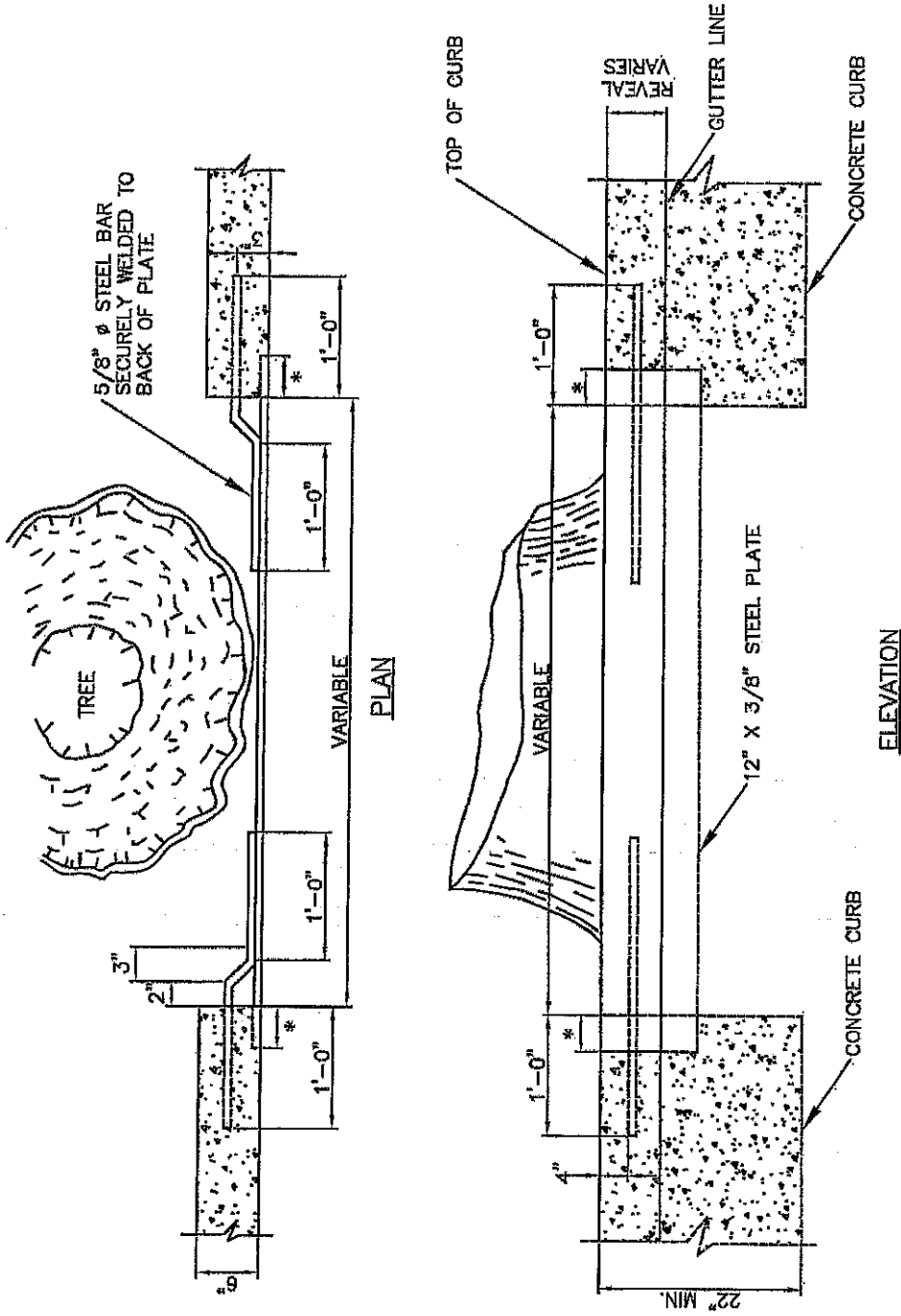

\* TREE PLATE SHALL EXTEND A MINIMUM OF 4" AND A MAXIMUM OF 6" PAST THE END OF THE ADJACENT CURB.

**Hanover**  
Engineering Associates Inc

5920 Hamilton Blvd., Suite 108  
Allentown, PA 18106-8942  
610-395-9222  
Fax 610-395-9262

DRAWN BY: ELH  
DATE: JUNE 2009  
SCALE: N. T. S.  
CHECKED BY: JLS  
SHEET NO. 1 OF 1

DETAIL C - TREE PLATE  
FOUNTAIN HILL BOROUGH  
LEHIGH COUNTY  
PENNSYLVANIA